



PSCL12050
PSCL 12V/5A switch
mode power supply



Edition: 2 from 13.10.2014
 Supersedes edition: 1 from 10.02.2014

EN

Features of the power supply unit:

- power output 5A/12VDC*
- universal AC input voltage range 90÷264V
- high efficiency 87%
- standby power <0,5W
- efficiency level: V
- IP 67 case
- protections:
 - SCP short-circuit protection
 - overvoltage protection (AC input)
 - overload (OLP)
- warranty – 2 year from the production date

1. Technical description.

1.1. General description.

Stabilized DC power supply is intended for supply equipments that require stabilised voltage of **12V DC**. When connected to fuse blocks of the LB4/xx/xx or LB8/xx/xx family, the power supply unit can feed more equipments (max. 4 or 8). The power supply unit is protected against short-circuit, overload and overvoltage.

1.2. Specifications.

Supply voltage	90 ÷ 264 V AC 50÷60Hz
Current consumption	0,6A@230VAC max.
Supply power	60W max.
Efficiency	87%
Output voltage	12V DC
Output current $t_{AMB}<30^{\circ}C$	5 A - refer to graph 1.
Output current $t_{AMB}=40^{\circ}C$	3,5 A - refer to graph 1.
Ripple voltage	100mV p-p max.
Short-circuit protection SCP	electronic, automatic recovery
Overload protection OLP	150-200% of power supply, automatic recovery
IP protection class	IP67
Operation conditions	temperature $-10^{\circ}C\div 40^{\circ}C$ relative humidity 20%...90% without condensation
Dimensions (LxWxH)	150 x 56 x 34 [mm]
Net/gross weight	0,40kg / 0,46kg
Protection class PN-EN 60950-1:2007	II (second)
Length of DC cable	0,5 m
Length of AC cable	0,3 m
Storage temperature	$-20^{\circ}C...+60^{\circ}C$

* In order to extend the life of the power supply, the load current of 3,5A is recommended.

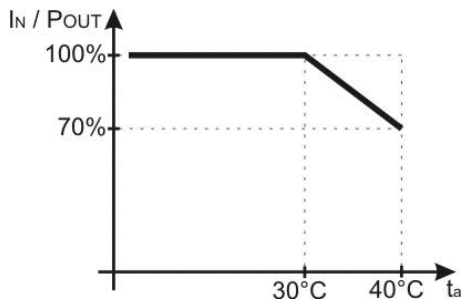

Graph 1.
 Relation between output current and ambient temperature (instantaneous load).

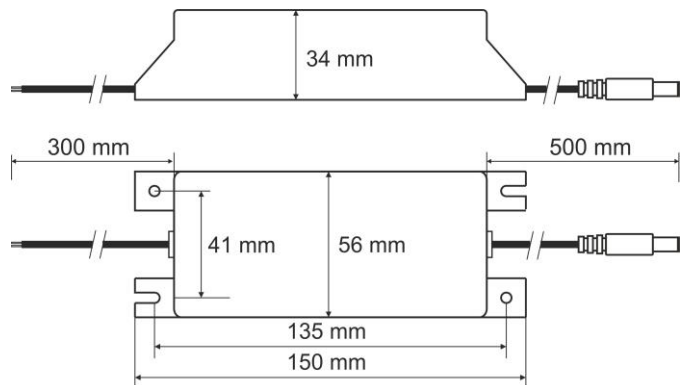

Fig.1. Dimensions of power supply.

* Refer to graph 1

1.3. Accessories.

For the power supplies are available accessories - fuse blocks and cable adapter. For details –visit www.pulsar.pl

2. Installation.

2.1. Requirements.

The power supply shall be mounted by the qualified installer having appropriate (required and necessary for a given country) permissions and qualifications for connecting (operating) low-voltage installations. The power supply shall be mounted in closed rooms, according to the environment class II, of the normal air humidity (RH=90% max.) and the temperature within the range from -10°C to +40°C.

In order to fulfill LVD and EMC requirements the rules for power supplies, encasing and shielding shall be observed according to application.

2.2. Installation procedure.

1. Connect the DC output to the load/loads.
2. Connect the power supply to the AC line. The power supply has to be installed in such way to keep the air flow around the supply unit.
3. After tests and operation control are performed, the casing (cubicle) shall be closed etc.

3. Maintenance.

Any and all maintenance operations may be performed following the disconnection of the power supply from the power network. The power supply does not require any specific maintenance procedures, however, in the case of significant level of dust, it should be cleaned with the compressed air.



WEEE designation

The waste electric and electronic equipment worn out may not be disposed of together with standard household waste. According to the WEEE directive, applicable in the EU, the separate neutralization methods should be used for electric and electronic equipment.

THE GENERAL WARRANTY CONDITIONS

1. Pulsar K. Bogusz Sp.j. (the manufacturer) grants a two-years warranty for the equipment, counted from the device's production date.
2. The warranty includes free-of-charge repair or replacement with an appropriate equivalent (the selection is at the manufacturer's discretion) if the malfunction is due to the manufacturer, includes manufacturing or material defects, unless such defects have been reported within the warranty period (item 1).
3. The equipment subject to warranty is to be brought to the place where it was purchased, or directly to the main office of the manufacturer.
4. The warranty applies to complete equipment, accompanied by a properly filled warranty claim with a description of the defect.
5. Should the claim be accepted, the manufacturer is obliged to provide warranty repairs, at the earliest convenience, however not later than within 14 days from the delivery to the service centre of the manufacturer.
6. The repair period mentioned in item 5 may be prolonged, if there are no technical possibilities to carry out the repairs, or if the equipment has been conditionally accepted, due to the breaking warranty terms by the claimant.
7. All the services rendered by force of the warranty are carried out at the service centre of the manufacturer, exclusively.
8. The warranty does not cover the defects of the equipment, resulting from:
 - reasons beyond the manufacturer's control,
 - mechanical damage,
 - improper storage and transport,
 - use that violates the operation manual or equipment's intended use
 - fortuitous events, including lightning discharges, power failures, fire, flood, high temperatures and chemical agents,
 - improper installation and configuration (in defiance with the manual),
9. The warranty is void in any of the following circumstances:
 - construction changes
 - repairs carried out by any unauthorized service center
 - damage or removal of warranty labels
 - modifications of the serial number
10. The liability of the manufacturer towards the buyer is limited to the value of the equipment, determined according to the wholesale prices suggested by the manufacturer on the day of purchase.
11. The manufacturer takes no responsibility for the defects that result from:
 - the damaging, malfunctioning or inability to operate the equipment
 - defects that result from using the equipment outside its stated specifications and operating parameters failing to abide by the recommendations and requirements contained in the manual, or the use of the equipment.

Pulsar K.Bogusz Sp.j.

Siedlec 150, 32-744 Łapczyca, Poland
Tel. (+48) 14-610-19-40, Fax. (+48) 14-610-19-50
e-mail: biuro@pulsar.pl, sales@pulsar.pl
http:// www.pulsar.pl, www.zasilacze.pl