

CODE: AWO250PU v.1.7/IV
NAME: 17/50/DSPR/PUSTA

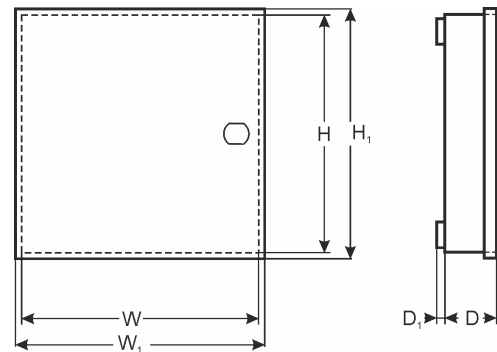

DESTINATION

DSC: PC1616, 1832, 1864, 4020 + 7x 5108 (4108, 5208, 5100, 4116)

PC1616, 1832, 1864, 4020 + 2x (5400, 5580, 4216) + 5x (4108, 5108, 5208, 5100, 4116)

PC1616, 1832, 1864, 4020+ (5204, 5200) + 6x 5108 (4108, 5208, 5100, 4116)

MODULES: 3x (5400, 5204, 5200, 5580, 4216) + 5x (5108, 4108, 5100, 4116, 5208)
 4204 + 7x (5108, 4108, 5100, 4116, 5208)

PARADOX: E55, E65, 728ULT, EVO48, EVO192, SP4000, SP5500, SP6000, SP7000) + 4x ZX8 (APR3-ADM2, APR3- HUB2, PGM4)

RISCO: PRO24, 116, 128, 140+ RP296EPS (RP128 EPS) + 3x EZ16 (E04, EZ8)

SATEL: CA4VI, CA5, CA6

VERSA5, 10 15, CA10 + 4 x CA10E (CA64E, SM, MST1)

INTEGRA24, 32 + 4x CA64E (SM)

INTEGRA64, 128 + 3x CA64E (SM)

MODULES: CA64 (PP, EPS, ADR, O-R, O- ROC, O-OC, OPS- OC, OPS- R, OPS- ROC, VGM- 16, SR, PT SA)+ 4x CA64E (SM)

PYRONIX: MATRIX 424, 816, 832, 832+

TEXECOM: PREMIER 412, 816, 832

PREMIER 48, 88, 168, 640 + COM 300 (ISDN)

TELMOR: TCA- 824+ 2x (TEX800) + TMT1

ROGER: PR402, CPR 32- SE

2x blacha KD (AWO432)

EBS: PX 202A

PULSAR: MS1012, MSR1012, MSRK1012

MS2012, MSR2012, MSRK2012

MSRK3012

TECHNICAL DATA

External dimensions of the enclosure: W=320, H=400, D+D1=120+8 [+/-2 mm]

External dimensions of the front panel: W1=325, H1=405 [+/-2 mm]

Weight net/gross: 2,70kg / 2,90kg [+/-0,1kg]

Battery space: 17Ah/12V Sealed Lead Acid (SLA)

Transformer: without transformer - can be mounted in the casing: TRP50, TRP80, TRZ50, TRZ80, TOR50, TOR80, TOR100, TOR150.

Tamper protection: 1 x microswitch: opening, 0,5A@50V/DC max. NC

Material description: sheet steel DC01, thickness: 0,7mm, protection anticorrosion, color: RAL 9003

Destination: indoor

Closing: screwed x 4

Notes: optional: lockable, distance from wall (mounting surface) - 8mm, easy door removal

Declaration, warranty: CE, 2 year from the production date